

ETP HYDRO-GRIP®

HSK Form A - DIN 69893

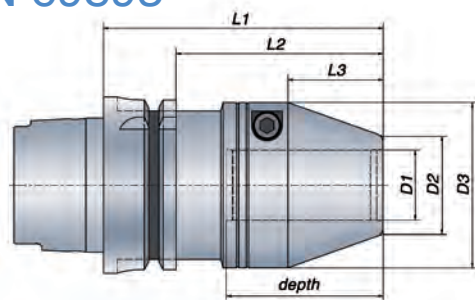

Metric range

Technical Specification HSK form A

| HSK size | Part no. | Item description | Dimensions, mm | | | | | | | | | | |
|----------|----------|------------------|-------------------|----|----|------|-----|-----|-------|-------|------------|--------------|--------|
| | | | D1 | D2 | D3 | L1 | L2 | L3 | depth | T* Nm | Weight kg | G 2.5 at rpm | |
| ● | 63 | 685630 | HG-12/HSK63A | 12 | 22 | 43.5 | 76 | 50 | 18 | 40 | 60 - 125 | 1.1 | 25 000 |
| ● | | 685640 | HG-12x100/HSK63A | 12 | 22 | 43.5 | 100 | 74 | 18 | 40 | 60 - 125 | 1.4 | 25 000 |
| ○ | | 685650 | HG-16/HSK63A | 16 | 26 | 48 | 86 | 60 | 28 | 50 | 165 - 270 | 1.2 | 25 000 |
| ○ | | 685660 | HG-16x125/HSK63A | 16 | 20 | 48 | 125 | 99 | 28 | 50 | 165 - 270 | 1.8 | 25 000 |
| ● | | 685670 | HG-20/HSK63A | 20 | 30 | 52 | 88 | 62 | 30 | 52 | 260 - 425 | 1.3 | 25 000 |
| ● | | 685680 | HG-20x150/HSK63A | 20 | 30 | 52 | 150 | 124 | 30 | 52 | 260 - 425 | 2.3 | 25 000 |
| ● | | 685690 | HG-25/HSK63A | 25 | 35 | 59 | 100 | 74 | 34 | 56 | 480 - 710 | 1.6 | 25 000 |
| ● | | 685700 | HG-25x150/HSK63A | 25 | 35 | 59 | 150 | 124 | 34 | 56 | 480 - 710 | 2.7 | 25 000 |
| ● | | 685710 | HG-32/HSK63A | 32 | 42 | 69.5 | 105 | 79 | 38 | 60 | 820 - 1250 | 2.0 | 25 000 |
| ● | 100 | 685720 | HG-12/HSK100A | 12 | 22 | 43.5 | 79 | 50 | 18 | 40 | 60 - 125 | 2.4 | 14 000 |
| ● | | 685730 | HG-12x100/HSK100A | 12 | 22 | 43.5 | 100 | 71 | 18 | 40 | 60 - 125 | 2.7 | 14 000 |
| ○ | | 685740 | HG-16/HSK100A | 16 | 26 | 48 | 89 | 60 | 28 | 50 | 165 - 270 | 2.6 | 14 000 |
| ○ | | 685750 | HG-16x125/HSK100A | 16 | 26 | 48 | 125 | 96 | 28 | 50 | 165 - 270 | 3.1 | 14 000 |
| ● | | 685760 | HG-20/HSK100A | 20 | 30 | 52 | 91 | 62 | 30 | 52 | 260 - 425 | 2.7 | 14 000 |
| ● | | 685770 | HG-20x150/HSK100A | 20 | 30 | 52 | 150 | 121 | 30 | 52 | 260 - 425 | 3.6 | 14 000 |
| ● | | 685780 | HG-25/HSK100A | 25 | 35 | 59 | 95 | 66 | 34 | 56 | 480 - 710 | 2.9 | 14 000 |
| ● | | 685790 | HG-25x150/HSK100A | 25 | 35 | 59 | 150 | 121 | 34 | 56 | 480 - 710 | 4.0 | 14 000 |
| ● | | 685800 | HG-32/HSK100A | 32 | 42 | 69.5 | 99 | 70 | 38 | 60 | 820 - 1250 | 3.3 | 14 000 |

Inch range

Technical Specification HSK form A

| HSK size | Part no. | Item description | Dimensions, inch | | | | | | | | | | |
|----------|----------|------------------|---------------------|-------|-------|-------|-------|-------|-------|----------|-----------|--------------|--------|
| | | | D1 | D2 | D3 | L1 | L2 | L3 | depth | T* ft-lb | Weight kg | G 2.5 at rpm | |
| ● | 63 | 685630-T | HG-1/2"/HSK63A | 0.500 | 0.866 | 1.713 | 2.992 | 1.969 | 0.709 | 1.575 | 55 - 105 | 1.1 | 25 000 |
| ○ | | 685640-T | HG-1/2"x100/HSK63A | 0.500 | 0.866 | 1.713 | 3.937 | 2.913 | 0.709 | 1.575 | 55 - 105 | 1.4 | 25 000 |
| ● | | 685670-T | HG-3/4"/HSK63A | 0.750 | 1.181 | 2.047 | 3.465 | 2.441 | 1.181 | 2.047 | 192 - 314 | 1.3 | 25 000 |
| ● | | 685680-T | HG-3/4"x150/HSK63A | 0.750 | 1.181 | 2.047 | 5.906 | 4.882 | 1.181 | 2.047 | 192 - 314 | 2.3 | 25 000 |
| ● | | 685690-T | HG-1"/HSK63A | 1.000 | 1.378 | 2.323 | 3.937 | 2.913 | 1.339 | 2.205 | 354 - 524 | 1.6 | 25 000 |
| ○ | | 685700-T | HG-1"x150/HSK63A | 1.000 | 1.378 | 2.323 | 5.906 | 4.882 | 1.339 | 2.205 | 354 - 524 | 2.7 | 25 000 |
| ● | | 685710-T | HG-1 1/4"/HSK63A | 1.250 | 1.654 | 2.736 | 4.134 | 3.110 | 1.496 | 2.362 | 605 - 922 | 2.0 | 25 000 |
| ○ | 100 | 685720-T | HG-1/2"/HSK100A | 0.500 | 0.866 | 1.713 | 3.110 | 1.969 | 0.709 | 1.575 | 55 - 105 | 2.4 | 14 000 |
| ○ | | 685730-T | HG-1/2"x100/HSK100A | 0.500 | 0.866 | 1.713 | 3.937 | 2.795 | 0.709 | 1.575 | 55 - 105 | 2.7 | 14 000 |
| ● | | 685760-T | HG-3/4"/HSK100A | 0.750 | 1.181 | 2.047 | 3.583 | 2.441 | 1.181 | 2.047 | 192 - 314 | 2.7 | 14 000 |
| ○ | | 685770-T | HG-3/4"x150/HSK100A | 0.750 | 1.181 | 2.047 | 5.906 | 4.764 | 1.181 | 2.047 | 192 - 314 | 3.6 | 14 000 |
| ● | | 685780-T | HG-1"/HSK100A | 1.000 | 1.378 | 2.323 | 3.740 | 2.598 | 1.339 | 2.205 | 354 - 524 | 2.9 | 14 000 |
| ○ | | 685790-T | HG-1"x150/HSK100A | 1.000 | 1.378 | 2.323 | 5.906 | 4.764 | 1.339 | 2.205 | 354 - 524 | 4.0 | 14 000 |
| ● | | 685800-T | HG-1 1/4"/HSK100A | 1.250 | 1.654 | 2.736 | 3.898 | 2.756 | 1.496 | 2.362 | 605 - 922 | 3.3 | 14 000 |

*) T = Min. and Max. transmittable torque using a h6 cylindrical tool, full depth insert. For additional information see section Technical Information.

- From stock
- On request

Information:

- Runout accuracy < 0.004 mm at 2.5 x D1 (max. 50 mm) ≤ 0.00016 inch at 2.5x D1 (max. 1.969 inch)
- Tool shank h6 or h7 can be used
- Center thread, M8x1.25, for axial length adjustment screw (screw not included)
- Coolant through on all holders
- Bore for data carrier

Accessories:

Use preset Torque Wrench, 6 Nm, to ensure correct mounting of tools. Part no. 19050

ETP HYDRO-GRIP can be used with reducing sleeves. For additional information see section Accessories.



ETP HYDRO-GRIP®

HSK Form C - DIN 69893

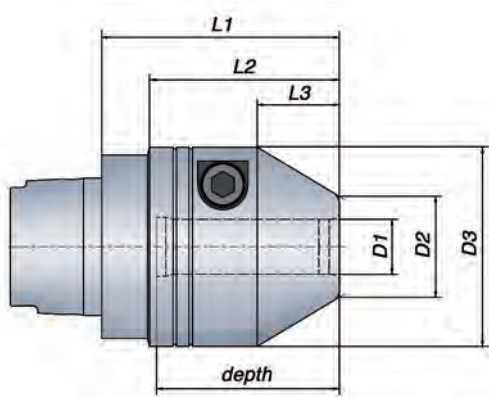

Technical Specification HSK form C

| HSK size | Part no. | Item description | Dimensions, mm | | | | | | | | | |
|----------|----------|------------------|----------------|----|------|----|------|----|-------|---------|-----------|--------------|
| | | | D1 | D2 | D3 | L1 | L2 | L3 | depth | T* | Weight kg | G 2.5 at rpm |
| ● 32 | 705667 | HG-12/HSK32C | 12 | 22 | 43.5 | 52 | 40.5 | 18 | 40 | 60-125 | 0.4 | 25 000 |
| ● 40 | 705668 | HG-12/HSK40C | 12 | 22 | 43.5 | 52 | 41.5 | 18 | 40 | 60-125 | 0.5 | 25 000 |
| ○ 50 | 705716 | HG-20/HSK50C | 20 | 30 | 52 | 67 | 54.5 | 30 | 52 | 260-425 | 0.8 | 25 000 |

*) T = Min. and Max. transmittable torque using a h6 cylindrical tool, full depth insert. For additional information see section Technical Information.

- From stock
- On request

Information:

- Runout accuracy ≤ 0.004 mm at $2.5 \times D1$ (max. 50 mm)
- ≤ 0.00016 inch at $2.5 \times D1$ (max. 1.969 inch)
- Tool shank h6 or h7 can be used
- Center thread, M8x1.25, for axial length adjustment screw (screw not included)
- Coolant through on all holders
- Bore for data carrier

Accessories:

Use preset Torque Wrench, 6 Nm, to ensure correct mounting of tools. Part no. 19050.

ETP HYDRO-GRIP can be used with reducing sleeves.
For additional information see section Accessories.



ETP HYDRO-GRIP®

HSK Form C - For HYDROMAT® Rotary transfer machines

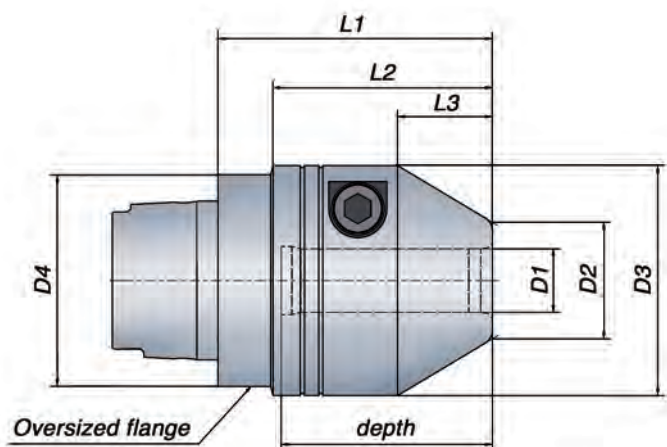

| Technical Specification HSK form C | | | | | | | | | | | | | |
|------------------------------------|----------|---------------------|----------------|----|------|----|----|------|----|-------|----------|-----------|--------------|
| HSK size | Part no. | Item description | Dimensions, mm | | | | | | | | | | |
| | | | D1 | D2 | D3 | D4 | L1 | L2 | L3 | depth | T* Nm | Weight kg | G 2.5 at rpm |
| ○ 32 | 705727 | HG-12/HSK32C - HM40 | 12 | 22 | 43.5 | 40 | 52 | 41.5 | 18 | 40 | 60-125 | 0.4 | 25 000 |
| ○ 40 | 705728 | HG-20/HSK40C - HM50 | 20 | 30 | 52 | 50 | 64 | 53.7 | 30 | 52 | 260-425 | 0.7 | 25 000 |
| ○ 50 | 705729 | HG-32/HSK50C - HM63 | 32 | 42 | 69.5 | 63 | 85 | 64.1 | 38 | 60 | 820-1250 | 1.6 | 25 000 |

*) T = Min. and Max. transmittable torque using a h6 cylindrical tool, full depth insert. For additional information see section Technical Information.

- From stock
- On request

Information:

- Runout accuracy ≤ 0.004 mm at $2.5 \times D1$ (max. 50 mm)
 ≤ 0.00016 inch at $2.5 \times D1$ (max. 1.969 inch)
- Tool shank h6 or h7 can be used
- Center thread, M8x1.25, for axial length adjustment screw (screw not included)
- Coolant through on all holders
- Bore for data carrier

Accessories:

Use preset Torque Wrench, 6 Nm, to ensure correct mounting of tools. Part no. 19050.

ETP HYDRO-GRIP can be used with reducing sleeves. For additional information see section Accessories.



ETP HYDRO-GRIP® COMPACT HSK Form F - DIN 69893

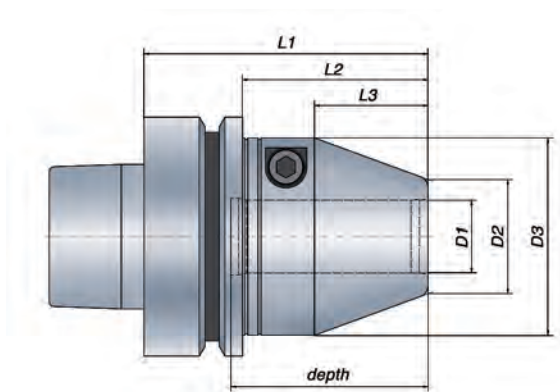

Metric range

Technical Specification HSK form F

| HSK size | Part no. | Item description | Dimensions, mm | | | | | | | | | |
|----------|----------|----------------------|----------------|----|------|----|----|----|-------|-----------|--------------|-----------------|
| | | | D1 | D2 | D3 | L1 | L2 | L3 | depth | T* Nm | Weight kg | G 2.5 at rpm |
| ● 63 | 705762 | HG COMPACT-12/HSK63F | 12 | 22 | 43.5 | 75 | 49 | 18 | 40 | 60 - 125 | 1.1 | 25 000 |
| ● | 705764 | HG COMPACT-16/HSK63F | 16 | 26 | 48 | 75 | 49 | 28 | 50 | 165 - 270 | 1.1 | 25 000 |
| ● | 705766 | HG COMPACT-20/HSK63F | 20 | 30 | 52 | 75 | 49 | 30 | 52 | 260 - 425 | 1.1 | 25 000 |

Inch range

Technical Specification HSK form F

| HSK size | Part no. | Item description | Dimensions, inch | | | | | | | | | |
|----------|----------|------------------------|------------------|-------|-------|-------|-------|-------|-------|-------------|--------------|-----------------|
| | | | D1 | D2 | D3 | L1 | L2 | L3 | depth | T* ft-lb | Weight kg | G 2.5 at rpm |
| ● 63 | 705763 | HG COMPACT-1/2"/HSK63F | 0.500 | 0.866 | 1.713 | 2.953 | 1.929 | 0.709 | 1.575 | 55 - 105 | 1.1 | 25 000 |
| ● | 705765 | HG COMPACT-5/8"/HSK63F | 0.625 | 1.024 | 1.890 | 2.953 | 1.929 | 1.102 | 1.969 | 122 - 199 | 1.1 | 25 000 |
| ● | 705681 | HG COMPACT-3/4"/HSK63F | 0.750 | 1.181 | 2.047 | 2.953 | 1.929 | 1.181 | 2.047 | 192 - 314 | 1.1 | 25 000 |

*) T = Min. and Max. transmittable torque using a h6 cylindrical tool, full depth insert. For additional information see section Technical Information.

- From stock
- On request

Information:

- Runout accuracy ≤ 0.004 mm at $2.5 \times D1$ (max. 50 mm)
 ≤ 0.00016 inch at $2.5 \times D1$ (max. 1.969 inch)
- Tool shank h6 or h7 can be used

Accessories:

Use preset Torque Wrench, 6 Nm, to ensure correct mounting of tools. Part no. 19050.

ETP HYDRO-GRIP COMPACT can be used with reducing sleeves.
For additional information see section Accessories.



ETP HYDRO-GRIP®

ISO Form AD/B - 7388-1

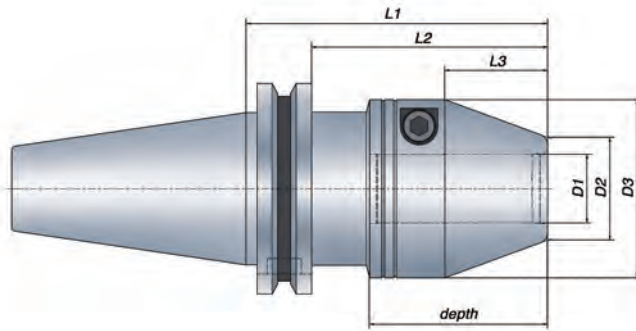

Metric range

Technical Specification ISO form AD/B

| Taper | Part no. | Item description | Dimensions, mm | | | | | | | | | T* Nm | Weight kg | G 2.5 at rpm |
|-------|----------|------------------|-----------------|----|------|-----|-------|-------|-------|----------|---------|----------|--------------|-----------------|
| | | | D1 | D2 | D3 | L1 | L2 | L3 | depth | | | | | |
| ● | 685810 | HG-12/ISO40 | 12 | 22 | 43.5 | 56 | 36.9 | 18 | 40 | 60-125 | 1.1 | 25 000 | | |
| | 685820 | HG-12x100/ISO40 | 12 | 22 | 43.5 | 100 | 80.9 | 18 | 40 | 60-125 | 1.6 | 25 000 | | |
| | ○ | 685830 | HG-16/ISO40 | 16 | 26 | 48 | 73 | 53.9 | 28 | 50 | 165-270 | 1.3 | 25 000 | |
| | ○ | 685840 | HG-16x125/ISO40 | 16 | 26 | 48 | 125 | 105.9 | 28 | 50 | 165-270 | 2.1 | 25 000 | |
| | ● | 685850 | HG-20/ISO40 | 20 | 30 | 52 | 88 | 68.9 | 30 | 52 | 260-425 | 1.6 | 25 000 | |
| | ● | 685860 | HG-20x125/ISO40 | 20 | 30 | 52 | 125 | 105.9 | 30 | 52 | 260-425 | 2.2 | 25 000 | |
| ● | 685870 | HG-25/ISO40 | 25 | 35 | 59 | 93 | 73.9 | 34 | 56 | 480-710 | 1.7 | 25 000 | | |
| ○ | 685880 | HG-12/ISO50 | 12 | 22 | 43.5 | 56 | 36.9 | 18 | 40 | 60-125 | 2.9 | 14 000 | | |
| | 685890 | HG-12x100/ISO50 | 12 | 22 | 43.5 | 100 | 80.9 | 18 | 40 | 60-125 | 3.4 | 14 000 | | |
| | 685900 | HG-16/ISO50 | 16 | 26 | 48 | 66 | 46.9 | 28 | 50 | 165-270 | 3.1 | 14 000 | | |
| | 685910 | HG-16x125/ISO50 | 16 | 26 | 48 | 125 | 105.9 | 28 | 50 | 165-270 | 3.9 | 14 000 | | |
| | ● | 685920 | HG-20/ISO50 | 20 | 30 | 52 | 68 | 48.9 | 30 | 52 | 260-425 | 3.1 | 14 000 | |
| | ● | 685930 | HG-20x150/ISO50 | 20 | 30 | 52 | 150 | 130.9 | 30 | 52 | 260-425 | 4.5 | 14 000 | |
| ● | 685940 | HG-25/ISO50 | 25 | 35 | 59 | 72 | 52.9 | 34 | 56 | 480-710 | 3.3 | 14 000 | | |
| ● | 685950 | HG-25x150/ISO50 | 25 | 35 | 59 | 150 | 130.9 | 34 | 56 | 480-710 | 4.9 | 14 000 | | |
| ● | 685960 | HG-32/ISO50 | 32 | 42 | 69.5 | 77 | 57.9 | 38 | 60 | 820-1250 | 3.6 | 14 000 | | |

Inch range

Technical Specification ISO form AD/B

| Taper | Part no. | Item description | Dimensions, inch | | | | | | | | | T* ft·lb | Weight kg | G 2.5 at rpm |
|-------|----------|-------------------|------------------|-------|-------|-------|-------|-------|-------|---------|-----|-------------|--------------|-----------------|
| | | | D1 | D2 | D3 | L1 | L2 | L3 | depth | | | | | |
| ○ | 685810-T | HG-1/2"/ISO40 | 0.500 | 0.866 | 1.713 | 2.205 | 1.453 | 0.709 | 1.575 | 55-105 | 1.1 | 25 000 | | |
| | 685820-T | HG-1/2"x100/ISO40 | 0.500 | 0.866 | 1.713 | 3.937 | 3.185 | 0.709 | 1.575 | 55-105 | 1.6 | 25 000 | | |
| | 685850-T | HG-3/4"/ISO40 | 0.750 | 1.181 | 2.047 | 3.465 | 2.713 | 1.181 | 2.047 | 192-314 | 1.6 | 25 000 | | |
| | 685860-T | HG-3/4"x125/ISO40 | 0.750 | 1.181 | 2.047 | 4.921 | 4.169 | 1.181 | 2.047 | 192-314 | 2.2 | 25 000 | | |
| | 685870-T | HG-1"/ISO40 | 1.000 | 1.378 | 2.323 | 3.661 | 2.909 | 1.339 | 2.205 | 354-524 | 1.7 | 25 000 | | |
| ○ | 685920-T | HG-3/4"/ISO50 | 0.750 | 1.181 | 2.047 | 2.677 | 1.925 | 1.181 | 2.047 | 192-314 | 3.1 | 14 000 | | |
| | 685930-T | HG-3/4"x150/ISO50 | 0.750 | 1.181 | 2.047 | 5.906 | 5.154 | 1.181 | 2.047 | 192-314 | 4.5 | 14 000 | | |
| | 685940-T | HG-1"/ISO50 | 1.000 | 1.378 | 2.323 | 2.835 | 2.083 | 1.339 | 2.205 | 354-524 | 3.3 | 14 000 | | |
| | 685950-T | HG-1"x150/ISO50 | 1.000 | 1.378 | 2.323 | 5.906 | 5.154 | 1.339 | 2.205 | 354-524 | 4.9 | 14 000 | | |
| | 685960-T | HG-1 1/4"/ISO50 | 1.250 | 1.654 | 2.736 | 3.031 | 2.280 | 1.496 | 2.362 | 605-922 | 3.6 | 14 000 | | |

*) T = Min. and Max. transmittable torque using a h6 cylindrical tool, full depth insert. For additional information see section Technical Information.

- From stock
- On request

Information:

- Runout accuracy < 0.004 mm at 2.5 x D1 (max. 50 mm)
- ≤ 0.00016 inch at 2.5x D1 (max. 1.969 inch)
- Tool shank h6 or h7 can be used
- Center thread, M8x1.25, for axial length adjustment screw (screw not included)
- Coolant through on all holders
- Bore for data carrier

Accessories:

Use preset Torque Wrench, 6 Nm, to ensure correct mounting of tools. Part no. 19050

ETP HYDRO-GRIP can be used with reducing sleeves. For additional information see section Accessories.



ETP HYDRO-GRIP®

BT Form AD - JIS B 6339

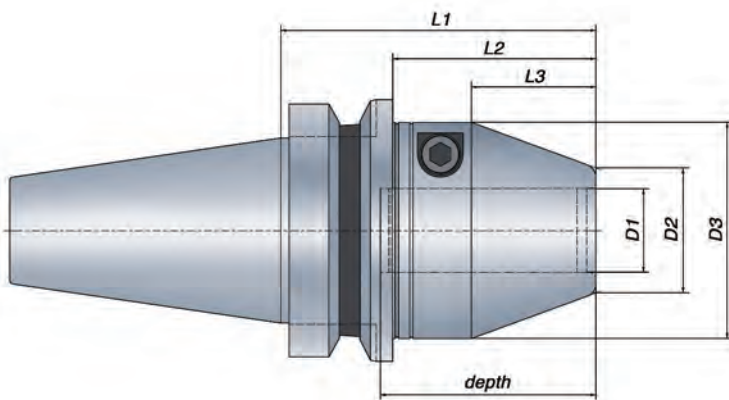

Metric range

Technical Specification BT form AD

| Taper | Part no. | Item description | Dimensions, mm | | | | | | | | | | |
|-------|----------|------------------|----------------|----|----|------|----|----|-------|----------|--------------|-----------------|--------|
| | | | D1 | D2 | D3 | L1 | L2 | L3 | depth | T* Nm | Weight kg | G 2.5 at rpm | |
| ● | 30 | 685970 | HG-12/BT30 | 12 | 22 | 43.5 | 59 | 37 | 18 | 40 | 60-125 | 0.7 | 25 000 |
| ○ | | 685980 | HG-16/BT30 | 16 | 26 | 48 | 69 | 47 | 28 | 50 | 165-270 | 1 | 25 000 |
| ● | | 685991 | HG-20/BT30 | 20 | 30 | 52 | 89 | 54 | 30 | 52 | 260-425 | 1.1 | 25 000 |

Inch range

Technical Specification BT form AD

| Taper | Part no. | Item description | Dimensions, inch | | | | | | | | | | |
|-------|----------|------------------|------------------|-------|-------|-------|-------|-------|-------|-------------|--------------|-----------------|--------|
| | | | D1 | D2 | D3 | L1 | L2 | L3 | depth | T* ft·lb | Weight kg | G 2.5 at rpm | |
| ● | 30 | 685970-T | HG-1/2"/BT30 | 0.500 | 0.866 | 1.713 | 2.323 | 1.457 | 0.709 | 1.575 | 55-105 | 0.7 | 25 000 |
| ● | | 685991-T | HG-3/4"/BT30 | 0.750 | 1.181 | 2.047 | 3.504 | 2.126 | 1.181 | 2.047 | 192-314 | 1.1 | 25 000 |

*) T = Min. and Max. transmittable torque using a h6 cylindrical tool, full depth insert. For additional information see section Technical Information.

- From stock
- On request

Information:

- Runout accuracy < 0.004 mm at 2.5 x D1 (max. 50 mm) ≤ 0.00016 inch at 2.5x D1 (max. 1.969 inch)
- Tool shank h6 or h7 can be used
- Center thread, M8x1.25, for axial length adjustment screw (screw not included)
- Coolant through on all holders
- Bore for data carrier - available on request

Accessories:

Use preset Torque Wrench, 6 Nm, to ensure correct mounting of tools. Part no. 19050

ETP HYDRO-GRIP can be used with reducing sleeves. For additional information see section Accessories.



ETP HYDRO-GRIP®

BT Form AD/B - JIS B 6339

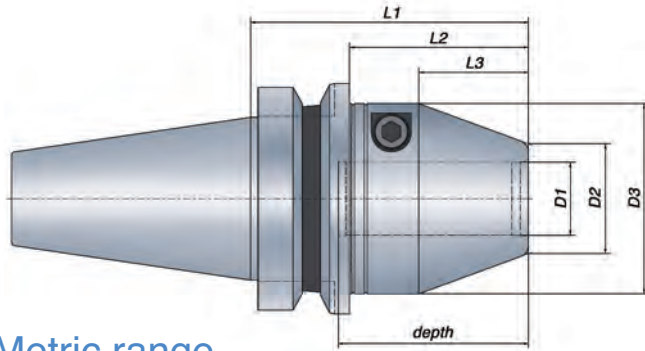

Metric range

| Technical Specification <i>BT form AD/B</i> | | | | | | | | | | | | | | | |
|---|----------|------------------|----------------|----|----|------|-----|-----|-------|----|----------|-----|----------|--------------|-----------------|
| Taper | Part no. | Item description | Dimensions, mm | | | | | | | | | | T* Nm | Weight kg | G 2.5 at rpm |
| | | | D1 | D2 | D3 | L1 | L2 | L3 | depth | | | | | | |
| ● | 40 | 685000 | HG-12/BT40 | 12 | 22 | 43.5 | 64 | 37 | 18 | 40 | 60-125 | 1.3 | 25 000 | | |
| ● | | 685010 | HG-12x100/BT40 | 12 | 22 | 43.5 | 100 | 73 | 18 | 40 | 60-125 | 1.7 | 25 000 | | |
| ○ | | 685020 | HG-16/BT40 | 16 | 26 | 48 | 74 | 47 | 28 | 50 | 165-270 | 1.4 | 25 000 | | |
| ○ | | 685030 | HG-16x125/BT40 | 16 | 26 | 48 | 125 | 98 | 28 | 50 | 165-270 | 1.9 | 25 000 | | |
| ● | | 685040 | HG-20/BT40 | 20 | 30 | 52 | 76 | 49 | 30 | 52 | 260-425 | 1.5 | 25 000 | | |
| ● | | 685050 | HG-20x125/BT40 | 20 | 30 | 52 | 125 | 98 | 30 | 52 | 260-425 | 2.3 | 25 000 | | |
| ● | | 685060 | HG-25/BT40 | 25 | 35 | 59 | 80 | 53 | 34 | 56 | 480-710 | 1.6 | 25 000 | | |
| ○ | 50 | 685070 | HG-12/BT50 | 12 | 22 | 43.5 | 75 | 37 | 18 | 40 | 60-125 | 3.9 | 14 000 | | |
| ○ | | 685080 | HG-12x100/BT50 | 12 | 22 | 43.5 | 100 | 62 | 18 | 40 | 60-125 | 4.3 | 14 000 | | |
| ○ | | 685090 | HG-16/BT50 | 16 | 26 | 48 | 85 | 47 | 28 | 50 | 165-270 | 4.1 | 14 000 | | |
| ○ | | 685100 | HG-16x125/BT50 | 16 | 26 | 48 | 125 | 87 | 28 | 50 | 165-270 | 4.6 | 14 000 | | |
| ● | | 685110 | HG-20/BT50 | 20 | 30 | 52 | 87 | 49 | 30 | 52 | 260-425 | 4.1 | 14 000 | | |
| ● | | 685120 | HG-20x150/BT50 | 20 | 30 | 52 | 150 | 112 | 30 | 52 | 260-425 | 5.2 | 14 000 | | |
| ● | | 685130 | HG-25/BT50 | 25 | 35 | 59 | 91 | 53 | 34 | 56 | 480-710 | 4.3 | 14 000 | | |
| ● | | 685140 | HG-25x150/BT50 | 25 | 35 | 59 | 150 | 112 | 34 | 56 | 480-710 | 5.5 | 14 000 | | |
| ● | | 685150 | HG-32/BT50 | 32 | 42 | 69.5 | 95 | 57 | 38 | 60 | 820-1250 | 4.5 | 14 000 | | |

Inch range

| Technical Specification <i>BT form AD/B</i> | | | | | | | | | | | | | | | |
|---|----------|------------------|------------------|-------|-------|-------|-------|-------|-------|-------|---------|-----|-------------|--------------|-----------------|
| Taper | Part no. | Item description | Dimensions, inch | | | | | | | | | | T* ft-lb | Weight kg | G 2.5 at rpm |
| | | | D1 | D2 | D3 | L1 | L2 | L3 | depth | | | | | | |
| ○ | 40 | 685000-T | HG-1/2"/BT40 | 0.500 | 0.866 | 1.713 | 2.520 | 1.457 | 0.709 | 1.575 | 55-105 | 1.3 | 25 000 | | |
| ○ | | 685010-T | HG-1/2"x100/BT40 | 0.500 | 0.866 | 1.713 | 3.937 | 2.874 | 0.709 | 1.575 | 55-105 | 1.7 | 25 000 | | |
| ○ | | 685040-T | HG-3/4"/BT40 | 0.750 | 1.181 | 2.047 | 2.992 | 1.929 | 1.181 | 2.047 | 192-314 | 1.5 | 25 000 | | |
| ○ | | 685050-T | HG-3/4"x125/BT40 | 0.750 | 1.181 | 2.047 | 4.921 | 3.858 | 1.181 | 2.047 | 192-314 | 2.3 | 25 000 | | |
| ○ | | 685060-T | HG-1"/BT40 | 1.000 | 1.378 | 2.323 | 3.150 | 2.087 | 1.339 | 2.205 | 354-524 | 1.6 | 25 000 | | |
| ○ | 50 | 685110-T | HG-3/4"/BT50 | 0.750 | 1.181 | 2.047 | 3.425 | 1.929 | 1.181 | 2.047 | 192-314 | 4.1 | 14 000 | | |
| ○ | | 685120-T | HG-3/4"x150/BT50 | 0.750 | 1.181 | 2.047 | 5.906 | 4.409 | 1.181 | 2.047 | 192-314 | 5.2 | 14 000 | | |
| ○ | | 685130-T | HG-1"/BT50 | 1.000 | 1.378 | 2.323 | 3.583 | 2.087 | 1.339 | 2.205 | 354-524 | 4.3 | 14 000 | | |
| ○ | | 685140-T | HG-1"x150/BT50 | 1.000 | 1.378 | 2.323 | 5.906 | 4.409 | 1.339 | 2.205 | 354-524 | 5.5 | 14 000 | | |
| ○ | | 685150-T | HG-1 1/4"/BT50 | 1.250 | 1.654 | 2.736 | 3.740 | 2.244 | 1.496 | 2.362 | 605-922 | 4.5 | 14 000 | | |

*) T = Min. and Max. transmittable torque using a h6 cylindrical tool, full depth insert. For additional information see section Technical Information.

- From stock
- On request

Information:

- Runout accuracy ≤ 0.004 mm at 2.5 x D1 (max. 50 mm), ≤ 0.00016 inch at 2.5x D1 (max. 1.969 inch)
- Tool shank h6 or h7 can be used
- Center thread, M8x1.25, for axial length adjustment screw (screw not included)
- Coolant thread on all holders
- Bore for data carrier

Accessories:

Use preset Torque Wrench, 6 Nm, to ensure correct mounting of tools. Part no. 19050.

ETP HYDRO-GRIP can be used with reducing sleeves. For additional information see section Accessories.



ETP HYDRO-GRIP®

CAT Form AD/B - ASME B5.50

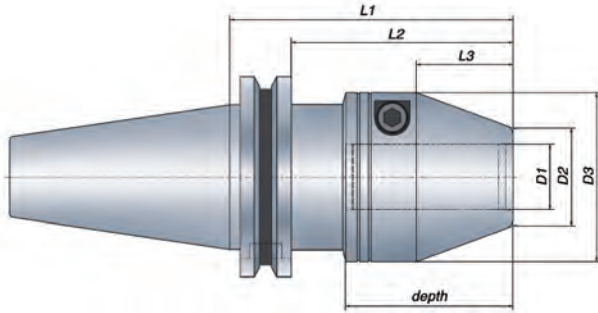

Metric range

Technical Specification CAT form AD/B

| Taper | Part no. | Item description | Dimensions, mm | | | | | | | | | T* Nm | Weight kg | G 2.5 at rpm |
|-------|----------|------------------|-----------------|----|----|------|-----|--------|-------|----|----------|----------|--------------|-----------------|
| | | | D1 | D2 | D3 | L1 | L2 | L3 | depth | | | | | |
| ● | 40 | 685470 | HG-12/CAT40 | 12 | 22 | 43.5 | 56 | 36.95 | 18 | 40 | 60-125 | 1.1 | 25 000 | |
| ● | | 685480 | HG-12x100/CAT40 | 12 | 22 | 43.5 | 100 | 80.95 | 18 | 40 | 60-125 | 1.6 | 25 000 | |
| ○ | | 685490 | HG-16/CAT40 | 16 | 26 | 48 | 86 | 66.95 | 28 | 50 | 165-270 | 1.5 | 25 000 | |
| ○ | | 685500 | HG-16x125/CAT40 | 16 | 26 | 48 | 125 | 105.95 | 28 | 50 | 165-270 | 2 | 25 000 | |
| ● | | 685510 | HG-20/CAT40 | 20 | 30 | 52 | 88 | 68.95 | 30 | 52 | 260-425 | 1.5 | 25 000 | |
| ● | | 685520 | HG-20x125/CAT40 | 20 | 30 | 52 | 125 | 105.95 | 30 | 52 | 260-425 | 2.1 | 25 000 | |
| ● | | 685530 | HG-25/CAT40 | 25 | 35 | 59 | 93 | 73.95 | 34 | 56 | 480-710 | 1.7 | 25 000 | |
| ○ | 50 | 685540 | HG-12/CAT50 | 12 | 22 | 43.5 | 56 | 36.95 | 18 | 40 | 60-125 | 2.8 | 14 000 | |
| ○ | | 685550 | HG-12x100/CAT50 | 12 | 22 | 43.5 | 100 | 80.95 | 18 | 40 | 60-125 | 3.2 | 14 000 | |
| ○ | | 685560 | HG-16/CAT50 | 16 | 26 | 48 | 66 | 46.95 | 28 | 50 | 165-270 | 3 | 14 000 | |
| ○ | | 685570 | HG-16x125/CAT50 | 16 | 26 | 48 | 125 | 105.95 | 28 | 50 | 165-270 | 3.5 | 14 000 | |
| ● | | 685580 | HG-20/CAT50 | 20 | 30 | 52 | 68 | 48.95 | 30 | 52 | 260-425 | 3 | 14 000 | |
| ● | | 685590 | HG-20x150/CAT50 | 20 | 30 | 52 | 150 | 130.95 | 30 | 52 | 260-425 | 4.4 | 14 000 | |
| ● | | 685600 | HG-25/CAT50 | 25 | 35 | 59 | 72 | 52.95 | 34 | 56 | 480-710 | 3.2 | 14 000 | |
| ● | | 685610 | HG-25x150/CAT50 | 25 | 35 | 59 | 150 | 130.95 | 34 | 56 | 480-710 | 4.8 | 14 000 | |
| ● | | 685620 | HG-32/CAT50 | 32 | 42 | 69.5 | 77 | 57.95 | 38 | 60 | 820-1250 | 3.5 | 14 000 | |

Inch range

Technical Specification CAT form AD/B

| Taper | Part no. | Item description | Dimensions, inch | | | | | | | | | T* ft-lb | Weight kg | G 2.5 at rpm |
|-------|----------|------------------|-------------------|-------|-------|-------|-------|-------|-------|-------|---------|-------------|--------------|-----------------|
| | | | D1 | D2 | D3 | L1 | L2 | L3 | depth | | | | | |
| ● | 40 | 685470-T | HG-1/2"/CAT40 | 0.500 | 0.866 | 1.713 | 2.205 | 1.455 | 0.709 | 1.575 | 55-105 | 1.1 | 25 000 | |
| ○ | | 685480-T | HG-1/2"x100/CAT40 | 0.500 | 0.866 | 1.713 | 3.937 | 3.187 | 0.709 | 1.575 | 55-105 | 1.6 | 25 000 | |
| ● | | 685510-T | HG-3/4"/CAT40 | 0.750 | 1.181 | 2.047 | 3.465 | 2.715 | 1.181 | 2.047 | 192-314 | 1.5 | 25 000 | |
| ● | | 682410-T | HG-3/4"x4"/CAT40 | 0.750 | 1.181 | 2.047 | 4.000 | 3.250 | 1.181 | 2.047 | 192-314 | 2.1 | 25 000 | |
| ● | | 685520-T | HG-3/4"x125/CAT40 | 0.750 | 1.181 | 2.047 | 4.921 | 4.171 | 1.181 | 2.047 | 192-314 | 2.1 | 25 000 | |
| ● | | 682420-T | HG-3/4"x6"/CAT40 | 0.750 | 1.181 | 2.047 | 6.000 | 5.250 | 1.181 | 2.047 | 192-314 | 2.6 | 25 000 | |
| ● | | 685530-T | HG-1"/CAT40 | 1.000 | 1.378 | 2.323 | 3.661 | 2.911 | 1.339 | 2.205 | 354-524 | 1.7 | 25 000 | |
| ● | 50 | 685580-T | HG-3/4"/CAT50 | 0.750 | 1.181 | 2.047 | 2.677 | 1.927 | 1.181 | 2.047 | 192-314 | 3 | 14 000 | |
| ● | | 682460-T | HG-3/4"x4"/CAT50 | 0.750 | 1.181 | 2.047 | 4.000 | 3.250 | 1.181 | 2.047 | 192-314 | 3.6 | 14 000 | |
| ● | | 682470-T | HG-3/4"x6"/CAT50 | 0.750 | 1.181 | 2.047 | 6.000 | 5.250 | 1.181 | 2.047 | 192-314 | 4.4 | 14 000 | |
| ● | | 685600-T | HG-1"/CAT50 | 1.000 | 1.378 | 2.323 | 2.835 | 2.085 | 1.339 | 2.205 | 354-524 | 3.2 | 14 000 | |
| ● | | 682480-T | HG-1"x4"/CAT50 | 1.000 | 1.378 | 2.323 | 4.000 | 3.250 | 1.339 | 2.205 | 354-524 | 3.8 | 14 000 | |
| ● | | 682490-T | HG-1"x6"/CAT50 | 1.000 | 1.378 | 2.323 | 6.000 | 5.250 | 1.339 | 2.205 | 354-524 | 4.9 | 14 000 | |
| ● | | 685620-T | HG-1 1/4"/CAT50 | 1.250 | 1.654 | 2.736 | 3.031 | 2.281 | 1.496 | 2.362 | 605-922 | 3.5 | 14 000 | |

*) T = Min. and Max. transmittable torque using a h6 cylindrical tool, full depth insert. For additional information see section Technical Information.

For ISO equivalents, please contact ETP customer service; sales@etpinc.com

● From stock

○ On request

Information:

- Runout accuracy ≤ 0.004 mm at $2.5 \times D1$ (max. 50 mm), ≤ 0.00016 inch at $2.5 \times D1$ (max. 1.969 inch)
- Tool shank h6 or h7 can be used
- Center thread, M8x1.25, for axial length adjustment screw (screw not included)
- Coolant through on all holders
- Bore for data carrier

Accessories:

Use preset Torque Wrench, 6 Nm, to ensure correct mounting of tools. Part no. 19050.

ETP HYDRO-GRIP can be used with reducing sleeves.

For additional information see section Accessories.



ETP HYDRO-GRIP®

CAT Form AD/B - ASME B5.50 Dual Contact

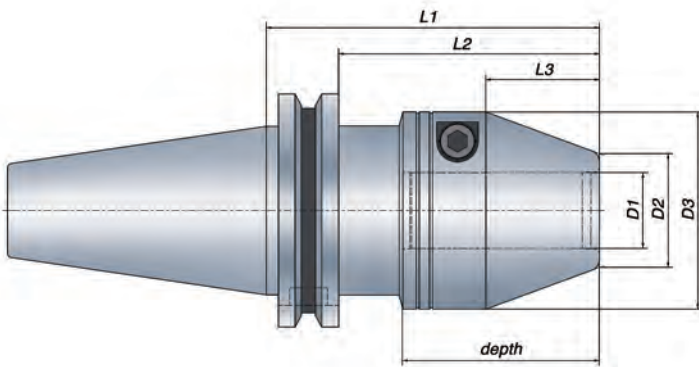

Metric range

Technical Specification CAT form AD/B Dual Contact

| Taper | Part no. | Item description | Dimensions, mm | | | | | | | | | | |
|-------|----------|------------------|----------------|----|----|----|-------|----|-------|-----------|--------------|-----------------|--|
| | | | D1 | D2 | D3 | L1 | L2 | L3 | depth | T* Nm | Weight kg | G 2.5 at rpm | |
| 40 | 681480 | HG-20/DC-CAT40 | 20 | 30 | 52 | 88 | 68.95 | 30 | 52 | 260 - 425 | 1.5 | 25 000 | |

*) T = Min. and Max. transmittable torque using a h6 cylindrical tool, full depth insert. For additional information see section Technical Information.

Inch range

Technical Specification CAT form AD/B Dual Contact

| Taper | Part no. | Item description | Dimensions, inch | | | | | | | | | | |
|-------|----------|------------------|------------------|-------|-------|-------|-------|-------|-------|-------------|--------------|-----------------|--|
| | | | D1 | D2 | D3 | L1 | L2 | L3 | depth | T* ft-lb | Weight kg | G 2.5 at rpm | |
| 40 | 681480-T | HG-3/4"/DC-CAT40 | 0.750 | 1.181 | 2.047 | 3.465 | 2.715 | 1.181 | 2.047 | 192 - 314 | 1.5 | 25 000 | |

*) T = Min. and Max. transmittable torque using a h6 cylindrical tool, full depth insert. For additional information see section Technical Information.

- From stock
- On request

Information:

- Runout accuracy ≤ 0.004 mm at $2.5 \times D1$ (max. 50 mm), ≤ 0.00016 inch at $2.5 \times D1$ (max. 1.969 inch)
- Tool shank h6 or h7 can be used
- Center thread, M8x1.25, for axial length adjustment screw (screw not included)
- Coolant through on all holders
- Bore for data carrier

Accessories:

Use preset Torque Wrench, 6 Nm, to ensure correct mounting of tools. Part no. 19050.

ETP HYDRO-GRIP can be used with reducing sleeves. For additional information see section Accessories.



ETP HYDRO-GRIP®

PSK Form - ISO 26623-1

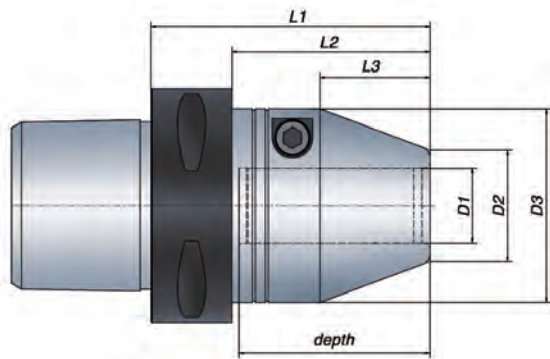

Metric range

Technical Specification PSK form

| Coupling size | Part no. | Item description | Dimensions, mm | | | | | | | | | |
|---------------|----------|-----------------------|----------------|----|------|-----|-----|----|-------|---------|-----------|--------------|
| | | | D1 | D2 | D3 | L1 | L2 | L3 | depth | T* Nm | Weight kg | G 2.5 at rpm |
| ● **) C3 | 701558 | HG-12/C3 (no gripper) | 12 | 22 | 43.5 | 50 | 43 | 18 | 40 | 60-125 | 0.4 | 25 000 |
| ● **) C4 | 703430 | HG-12/C4 (no gripper) | 12 | 22 | 43.5 | 50 | 43 | 18 | 40 | 60-125 | 0.5 | 25 000 |
| ● C4 | 685160 | HG-12/C4 | 12 | 22 | 43.5 | 62 | 43 | 18 | 40 | 60-125 | 0.6 | 25 000 |
| ● | 685170 | HG-12x100/C4 | 12 | 22 | 43.5 | 100 | 43 | 18 | 40 | 60-125 | 1 | 25 000 |
| ○ | 685180 | HG-16/C4 | 16 | 26 | 48 | 72 | 52 | 28 | 50 | 165-270 | 0.7 | 25 000 |
| ○ | 685190 | HG-16x125/C4 | 16 | 26 | 48 | 125 | 52 | 28 | 50 | 165-270 | 1.2 | 25 000 |
| ● | 685200 | HG-20/C4 | 20 | 30 | 52 | 75 | 55 | 30 | 52 | 260-425 | 0.8 | 25 000 |
| ● | 685210 | HG-20x125/C4 | 20 | 30 | 52 | 125 | 105 | 30 | 52 | 260-425 | 1.6 | 25 000 |
| ● C5 | 685220 | HG-12/C5 | 12 | 22 | 43.5 | 62 | 42 | 18 | 40 | 60-125 | 0.8 | 25 000 |
| ● | 685230 | HG-12x100/C5 | 12 | 22 | 43.5 | 100 | 80 | 18 | 40 | 60-125 | 1.2 | 25 000 |
| ○ | 685240 | HG-16/C5 | 16 | 26 | 48 | 72 | 52 | 28 | 50 | 165-270 | 1 | 25 000 |
| ○ | 685250 | HG-16x125/C5 | 16 | 26 | 48 | 125 | 105 | 28 | 50 | 165-270 | 1.5 | 25 000 |
| ● | 685260 | HG-20/C5 | 20 | 30 | 52 | 74 | 54 | 30 | 52 | 260-425 | 1 | 25 000 |
| ● | 685270 | HG-20x125/C5 | 20 | 30 | 52 | 125 | 54 | 30 | 52 | 260-425 | 1.8 | 25 000 |
| ● | 685280 | HG-25/C5 | 25 | 35 | 59 | 79 | 59 | 34 | 56 | 480-710 | 1.2 | 25 000 |

Inch range

Technical Specification PSK form

| Coupling size | Part no. | Item description | Dimensions, inch | | | | | | | | | |
|---------------|----------|------------------|------------------|-------|-------|-------|-------|-------|-------|----------|-----------|--------------|
| | | | D1 | D2 | D3 | L1 | L2 | L3 | depth | T* ft-lb | Weight kg | G 2.5 at rpm |
| ● C4 | 685200-T | HG-3/4"/C4 | 0.750 | 1.181 | 2.047 | 2.953 | 2.165 | 1.181 | 2.047 | 192-314 | 0.8 | 25 000 |
| ● C5 | 685280-T | HG-1"/C5 | 1.000 | 1.378 | 2.323 | 3.110 | 2.323 | 1.339 | 2.205 | 354-524 | 1.2 | 25 000 |

*) T = Min. and Max transmittable torque using a h6 cylindrical tool, full depth insert. For additional information see section Technical Information.

Additional PSK Inch equivalents add "-T" to metric part no. Available on request.

**) Short version with no gripper grooves.

- From stock
- On request

Information:

- Runout accuracy ≤ 0.004 mm at $2.5 \times D1$ (max. 50 mm), ≤ 0.00016 inch at $2.5 \times D1$ (max. 1.969 inch)
- Tool shank h6 or h7 can be used
- Center thread, M8x1.25, for axial length adjustment screw (screw not included)
- Coolant through on all holders
- Bore for data carrier

Accessories:

Use preset Torque Wrench, 6 Nm, to ensure correct mounting of tools. Part no. 19050.

ETP HYDRO-GRIP can be used with reducing sleeves. For additional information see section Accessories.



ETP HYDRO-GRIP®

PSK Form - ISO 26623-1

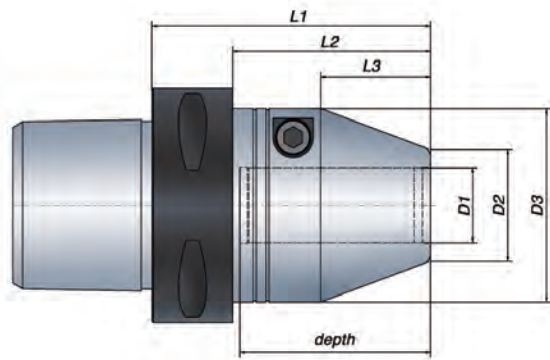

Metric range

Technical Specification PSK form

| Coupling size | Part no. | Item description | Dimensions, mm | | | | | | | | | T* Nm | Weight kg | G 2.5 at rpm |
|---------------|----------|------------------|----------------|----|------|------|-----|-----|-------|---------|----------|--------|-----------|--------------|
| | | | D1 | D2 | D3 | L1 | L2 | L3 | depth | | | | | |
| ● | 685290 | HG-12/C6 | 12 | 22 | 43.5 | 64 | 42 | 18 | 40 | 60-125 | 1.1 | 25 000 | | |
| | 685300 | HG-12x100/C6 | 12 | 22 | 43.5 | 100 | 78 | 18 | 40 | 60-125 | 1.5 | 25 000 | | |
| | ○ | 685310 | HG-16/C6 | 16 | 26 | 48 | 74 | 52 | 28 | 50 | 165-270 | 1.2 | 25 000 | |
| | ○ | 685320 | HG-16x125/C6 | 16 | 26 | 48 | 125 | 103 | 28 | 50 | 165-270 | 1.7 | 25 000 | |
| | ● | 685330 | HG-20/C6 | 20 | 30 | 52 | 76 | 54 | 30 | 52 | 260-425 | 1.3 | 25 000 | |
| | ● | 685340 | HG-20x150/C6 | 20 | 30 | 52 | 150 | 128 | 30 | 52 | 260-425 | 2.5 | 25 000 | |
| | ● | 685350 | HG-25/C6 | 25 | 35 | 59 | 80 | 58 | 34 | 56 | 480-710 | 1.5 | 25 000 | |
| | ● | 685360 | HG-25x150/C6 | 25 | 35 | 59 | 150 | 128 | 34 | 56 | 480-710 | 3 | 25 000 | |
| | ● | 685370 | HG-32/C6 | 32 | 42 | 69.5 | 84 | 62 | 38 | 60 | 820-1250 | 1.8 | 25 000 | |
| ○ | 685380 | HG-12/C8 | 12 | 22 | 43.5 | 67 | 37 | 18 | 40 | 60-125 | 2.1 | 14 000 | | |
| | 685390 | HG-12x100/C8 | 12 | 22 | 43.5 | 100 | 70 | 18 | 40 | 60-125 | 2.5 | 14 000 | | |
| | 685400 | HG-16/C8 | 16 | 26 | 48 | 77 | 47 | 28 | 50 | 165-270 | 2.2 | 14 000 | | |
| | 685410 | HG-16x125/C8 | 16 | 26 | 48 | 125 | 95 | 28 | 50 | 165-270 | 2.7 | 14 000 | | |
| | ● | 685420 | HG-20/C8 | 20 | 30 | 52 | 79 | 49 | 30 | 52 | 260-425 | 2.3 | 14 000 | |
| | ● | 685430 | HG-20x150/C8 | 20 | 30 | 52 | 150 | 120 | 30 | 52 | 260-425 | 3.4 | 14 000 | |
| | ● | 685440 | HG-25/C8 | 25 | 35 | 59 | 83 | 53 | 34 | 56 | 480-710 | 2.4 | 14 000 | |
| | ● | 685450 | HG-25x150/C8 | 25 | 35 | 59 | 150 | 120 | 34 | 56 | 480-710 | 3.8 | 14 000 | |
| | ● | 685460 | HG-32/C8 | 32 | 42 | 69.5 | 87 | 57 | 38 | 60 | 820-1250 | 2.7 | 14 000 | |

Inch range

Technical Specification PSK form

| Coupling size | Part no. | Item description | Dimensions, inch | | | | | | | | | T* Nm | Weight kg | G 2.5 at rpm |
|---------------|----------|------------------|------------------|-------|-------|-------|-------|-------|-------|---------|-----|--------|-----------|--------------|
| | | | D1 | D2 | D3 | L1 | L2 | L3 | depth | | | | | |
| C6 | 685290-T | HG-1/2"/C6 | 0.500 | 0.866 | 1.713 | 2.520 | 1.654 | 0.709 | 1.575 | 55-105 | 1.1 | 25 000 | | |
| | 685330-T | HG-3/4"/C6 | 0.750 | 1.181 | 2.047 | 2.992 | 2.126 | 1.181 | 2.047 | 192-314 | 1.3 | 25 000 | | |
| | 685350-T | HG-1"/C6 | 1.000 | 1.378 | 2.323 | 3.150 | 2.283 | 1.339 | 2.205 | 354-524 | 1.5 | 25 000 | | |

* T = Min. and Max transmittable torque using a h6 cylindrical tool, full depth insert. For additional information see section Technical Information.

Additional PSK Inch equivalents add "-T" to metric part no. Available on request.

- From stock
- On request

Information:

- Runout accuracy ≤ 0.004 mm at $2.5 \times D1$ (max. 50 mm), ≤ 0.00016 inch at $2.5 \times D1$ (max. 1.969 inch)
- Tool shank h6 or h7 can be used
- Center thread, M8x1.25, for axial length adjustment screw (screw not included)
- Coolant through on all holders
- Bore for data carrier

Accessories:

Use preset Torque Wrench, 6 Nm, to ensure correct mounting of tools. Part no. 19050.

ETP HYDRO-GRIP can be used with reducing sleeves. For additional information see section Accessories.

