



ETP HYDRO-GRIP® HSK 63F

Hydraulic high precision toolholder



The short design of 75 mm makes ETP HYDRO-GRIP your ideal replacement for any ER collet holder.

Allowing more and more users to fully benefit from all the positives of hydraulic clamping such as easy handling and decreased tool wear.

ETP HYDRO-GRIP has a very compact and robust design. Tools changes are made quickly, easily and with a high level of precision.

The high clamping force guarantees a secure clamping of your milling, drilling and reaming tools. With a

minimum tool runout a good surface finish is achieved along with an extended tool life.

ETP HYDRO-GRIP can be used with reduction sleeves for maximum flexibility. Versions for internal and peripheral cooling available.

BENEFITS & FEATURES

- Short overhang
- Easy handling
- High clamping force
- Can be used with reduction sleeves



EASY MOUNTING WITH
TORQUE WRENCH



HIGH RUNOUT ACCURACY



VIBRATION
DAMPING



FAST SET-UP TIME

ETP HYDRO-GRIP® HSK

Form F - DIN 69893

Information:

- Runout accuracy ≤ 0.004 mm at $2.5 \times D1$ (max. 50 mm)
 ≤ 0.00016 inch at $2.5 \times D1$ (max. 1.969 inch)
- Tool shank h6 or h7 can be used
- Center thread, M8x1.25, for axial length adjustment screw (screw not included)
- Coolant through on all holders

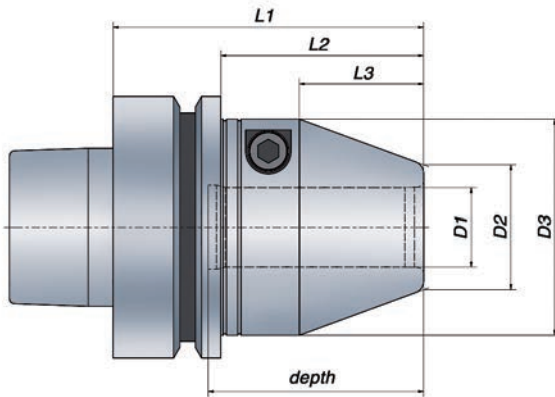

Inch range

Technical Specification HSK form F

HSK size	Part no.	Item description	Dimensions, inch							T*min ft·lb	Weight kg	G 2.5 at rpm
			D1	D2	D3	L1	L2	L3	depth			
63	705681	HG-3/4"/HSK63F	0.750	1.181	2.047	2.953	1.929	1.181	2.047	192	1.1	25 000

*) T_{min} = Minimum transmittable torque using a h6 cylindrical tool, full depth insert. For additional information see section Technical Information.
L1 = programming length

Accessories

To get the best out of your ETP high precision toolholders, always use ETP accessories.

For additional information contact ETP.



HYDRO-GRIP Torque wrench

Item description	Tightening torque:	Part no.
Torque wrench (5 mm Hex)	6 Nm (4.4 ft · lb)	19050

Use torque wrench to ensure correct tightening independent on user. Should be used with all HYDRO-GRIP holders.

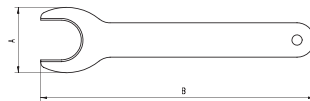

Extractor

Item description	Part no.	For Sizes	A [mm]	B [mm]
EHS 20 - 3/4"	E7321.20000	HS 20 - 3/4"	38.0	160

The extractor helps to remove the reduction sleeve from the toolholder.

● = From stock

Reduction Sleeves inch to inch

Item description	d [inch"]	Part no.	D1 [inch"]	D2 [inch"]	L1 [inch"]	L2 [inch"]	L3 [inch"]
Reduction Sleeves HS 3/4"							
● HS 3/4" / 1/8"	0.1250	R1919.03182	0.750	0.984	1.969	1.102	0.157
● HS 3/4" / 3/16"	0.1875	R1919.04762	0.750	0.984	1.969	1.102	0.157
● HS 3/4" / 1/4"	0.2500	R1919.06352	0.750	0.984	1.969	1.417	0.157
● HS 3/4" / 5/16"	0.3125	R1919.07942	0.750	0.984	1.969	1.457	0.157
● HS 3/4" / 3/8"	0.3750	R1919.09522	0.750	0.984	1.969	1.417	0.157
● HS 3/4" / 7/16"	0.4375	R1919.11112	0.750	0.984	1.969	1.575	0.157
● HS 3/4" / 1/2"	0.5000	R1919.12702	0.750	0.984	1.969	1.772	0.157
● HS 3/4" / 9/16"	0.5625	R1919.14292	0.750	0.984	1.969	1.772	0.157
● HS 3/4" / 5/8"	0.6250	R1919.15882	0.750	0.984	1.969	1.890	0.157
Reduction Sleeves HS 3/4"-CF							
● HS 3/4"-CF / 1/4"	0.2500	R1919.06353	0.750	0.984	1.969	1.417	0.157
● HS 3/4"-CF / 3/8"	0.3750	R1919.09523	0.750	0.984	1.969	1.417	0.157
● HS 3/4"-CF / 1/2"	0.5000	R1919.12703	0.750	0.984	1.969	1.772	0.157
● HS 3/4"-CF / 5/8"	0.6250	R1919.15883	0.750	0.984	1.969	1.890	0.157

BENEFITS & FEATURES

Standard version HS suited for internal cooling

Metal-to-metal seal for cutting tools with internal coolant channels.

HS-CF version suited for peripheral cooling

The coolant flush reduction sleeves HS-CF can be used for peripheral cooling due to their coolant channels.

