



# ETP HYDRO-GRIP® S Grinding holder



We are happy to introduce our newest addition to the range of high quality hydraulic toolholders – **HYDRO-GRIP Grinding holders**. With the combination of extreme high

precision and easy handling and tool change a massive improvement in productivity can be reached. Quicker set-up times and improved repeat accuracy during sharpening of tools

will save you time and money. The possibility to use reduction sleeves in the hydraulic holder also increases your flexibility.

## BENEFITS & FEATURES

- High run-out accuracy  $\leq 0,004$  mm.
- Easy handling and tool change.
- High clamping force.
- Vibration dampening.
- Flexibility in clamping range – use of reduction sleeves possible.



EASY MOUNTING WITH  
TORQUE WRENCH



HIGH RUNOUT ACCURACY



VIBRATION  
DAMPING



FAST SET-UP TIME

# ETP HYDRO-GRIP® S

## ISO Form AD - 7388-1

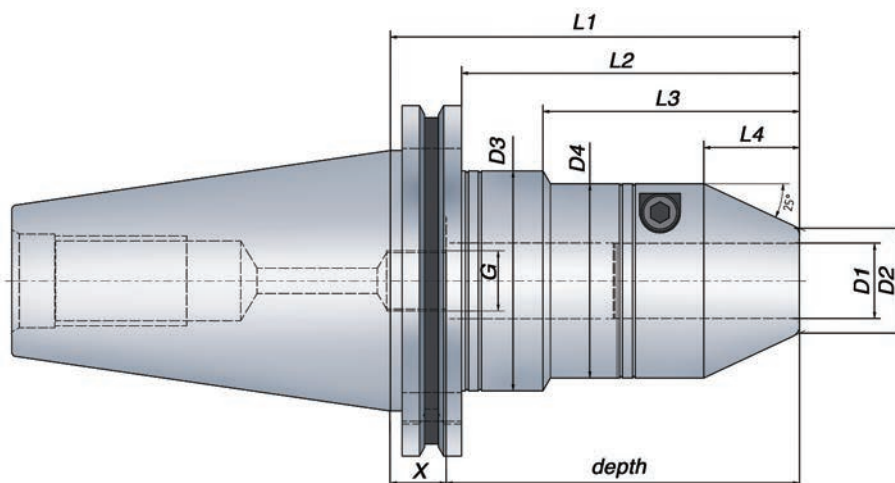

### Metric range

#### Technical Specification ISO form AD

Taper	Part no.	Item description	Dimensions, mm												
			D1	D2	D3	D4	L1	L2	L3	L4	depth	G	X	T*min Nm	Weight kg
● 50	703763	ETP HG S-12x110/ISO50	12	21.5	59	43.5	110	90.9	69	23.6	50	M8x1	60	60	3.7
●	704378	ETP HG S-20x110/ISO50	20	28	59	52	110	90.9	69	25.7	95	M16x1	15	260	3.8
●	703764	ETP HG S-32x110/ISO50	32	40	69.5	-	110	90.9	-	31.6	95	M16x1	15	260	4.3

### Inch range

#### Technical Specification ISO form AD

Taper	Part no.	Item description	Dimensions, inch												
			D1	D2	D3	D4	L1	L2	L3	L4	depth	G	X	T*min ft-lb	Weight kg
● 50	703763-T	ETP HG S-1/2"x110/ISO50	0.500	0.846	2.323	1.713	4.331	3.579	2.717	0.929	1.969	M8x1	2.362	44	3.7
●	704378-T	ETP HG S-3/4"x110/ISO50	0.750	1.102	2.323	2.047	4.331	3.579	2.717	1.012	3.740	M16x1	0.591	192	3.8

● From stock

\*) T<sub>min</sub> = Minimum transmittable torque using a h6 cylindrical tool, full depth insert.

L1 = programming length

#### Information:

- Runout accuracy ≤ 0.004 mm at 2.5 x D1 (max. 50 mm)  
≤ 0.00016 inch at 2.5x D1 (max. 1.969 inch)
- Tool shank h6 or h7 can be used
- Coolant through on all holders
- Bore for data carrier

#### Accessories:

Use preset Torque Wrench, 6 Nm, to ensure correct mounting of tools. Part no. 19050

ETP HYDRO-GRIP S can be used with reduction sleeves.  
For additional information contact ETP.

