

# ETP ECOGRIP™

## ISO Form AD/B - 7388-1

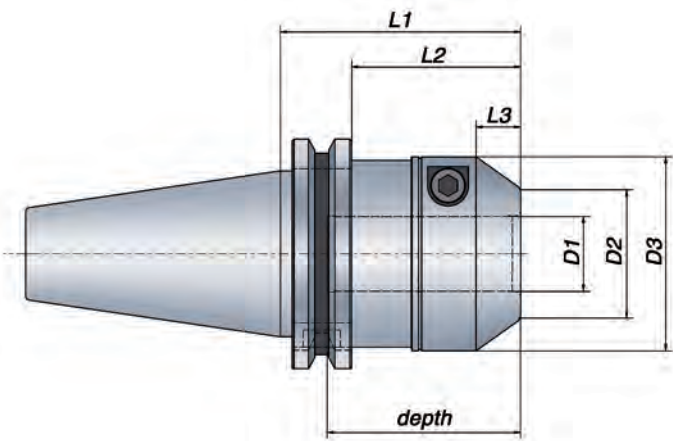

Technical Specification ISO form AD/B													
Taper	Part no.	Item description	Dimensions, mm										
			D1	D2	D3	L1	L2	L3	depth	T* Nm	Weight kg	G 2.5 at rpm	
● 40	687580	ECOGRIP-20/ISO40	20	35	52	64.5	45.4	12	52	400-535	1.3	25 000	
● 50	687600	ECOGRIP-32/ISO50	32	47	69.5	61	41.9	12	60	1325 - 1670	3.0	14 000	

\*) T = Min. and Max. transmittable torque using a h6 cylindrical tool, full depth insert. For additional information see section Technical Information.

- From stock
- On request

### Information:

- Runout accuracy  $\leq 0.004$  mm at  $2.5 \times D1$  (max. 50 mm)  
 $\leq 0.00016$  inch at  $2.5 \times D1$  (max. 1.969 inch)
- Tool shank h6 or h7 can be used
- Center thread, M8x1.25, for axial length adjustment screw (screw not included)
- Coolant through on all holders
- Bore for data carrier

### Accessories:

Use preset Torque Wrench, 10 Nm, to ensure correct mounting of tools. Part no. 19052.

ETP ECOGRIP can be used with reducing sleeves.  
For additional information see section Accessories.



# ETP ECOGRIP™

## BT Form AD - JIS B 6339

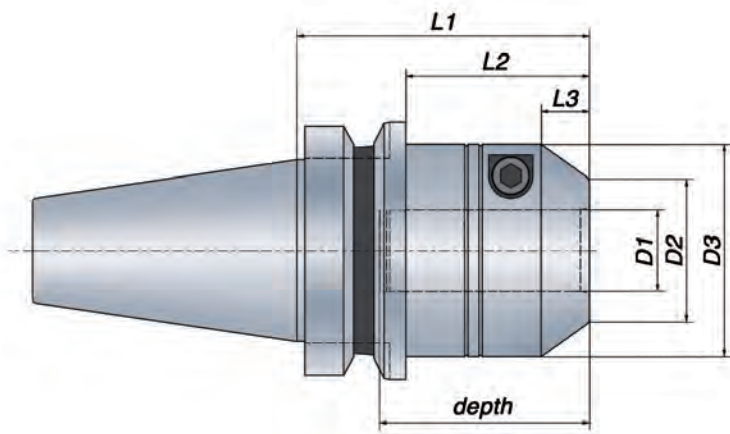

### Metric range

#### Technical Specification BT form AD/B

Taper	Part no.	Item description	Dimensions, mm							depth	T* Nm	Weight kg	G 2.5 at rpm
			D1	D2	D3	L1	L2	L3					
● 30	687500	ECOGRIP-12/BT30	12	28	43.5	69	47	12	40	85 - 150	0.8	25 000	
●	687510	ECOGRIP-20/BT30	20	35	52	76	35.2	12	52	400 - 535	1	25 000	

\*) T = Min. and Max. transmittable torque using a h6 cylindrical tool, full depth insert. For additional information see section Technical Information.

● From stock

○ On request

#### Information:

- Runout accuracy  $\leq 0.004$  mm at  $2.5 \times D1$  (max. 50 mm),  $\leq 0.00016$  inch at  $2.5 \times D1$  (max. 1.969 inch)
- Tool shank h6 or h7 can be used
- Center thread, for axial length adjustment screw (screw not included)  
Size 12: M6x1. Size 20: M8x1.25
- Coolant through on all holders

#### Accessories:

Use preset Torque Wrench, 10 Nm, to ensure correct mounting of tools. Part no. 19052.

ETP ECOGRIP can be used with reducing sleeves.

For additional information see section Accessories.



# ETP ECOGRIP™

## BT Form AD/B - JIS B 6339

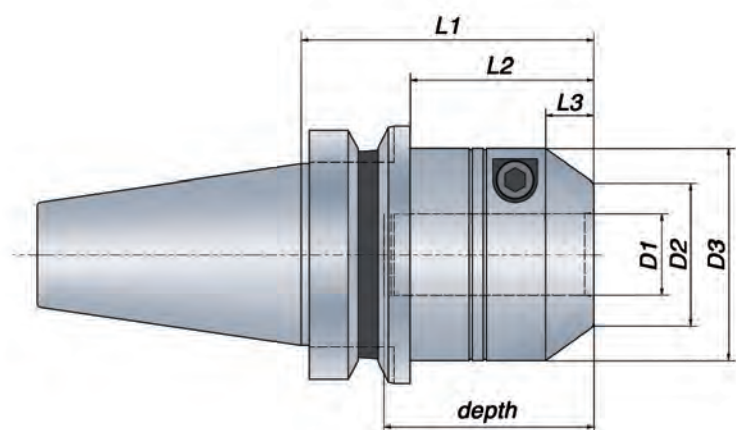

### Metric range

#### Technical Specification BT form AD/B

Taper	Part no.	Item description	Dimensions, mm										
			D1	D2	D3	L1	L2	L3	depth	T* Nm	Weight kg	G 2.5 at rpm	
● 40	687520	ECOGRIP-12/BT40	12	28	43.5	58	31	12	40	85 - 150	1.2	25 000	
● 40	687530	ECOGRIP-20/BT40	20	35	52	72.5	45.5	12	52	400-535	1.5	25 000	
● 50	687560	ECOGRIP-32/BT50	32	47	69.5	90	52	12	60	1325 - 1670	4.6	14 000	

\*) T = Min. and Max. transmittable torque using a h6 cylindrical tool, full depth insert. For additional information see section Technical Information.

- From stock
- On request

#### Information:

- Runout accuracy  $\leq 0.004$  mm at  $2.5 \times D1$  (max. 50 mm),  $\leq 0.00016$  inch at  $2.5 \times D1$  (max. 1.969 inch)
- Tool shank h6 or h7 can be used
- Center thread, for axial length adjustment screw (screw not included)  
Size 12: M6x1. Size 20: M8x1.25
- Coolant through on all holders
- Bore for data carrier - available on request

#### Accessories:

Use preset Torque Wrench, 10 Nm, to ensure correct mounting of tools. Part no. 19052.

ETP ECOGRIP can be used with reducing sleeves.  
For additional information see section Accessories.



# ETP HYDRO-GRIP®

## CAT Form AD/B - ASME B5.50

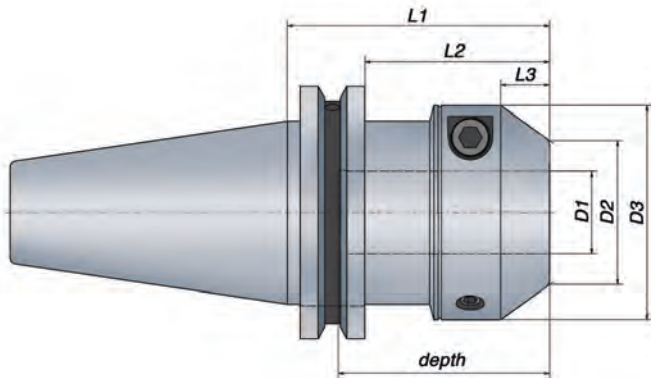

### Metric range

#### Technical Specification CAT form AD/B

Taper	Part no.	Item description	Dimensions, mm								T* Nm	Weight kg	G 2.5 at rpm
			D1	D2	D3	L1	L2	L3	depth				
40	687620	ECOGRIP-20/CAT40	20	35	52	64.5	45.45	12	52	400 - 535	1.3	25 000	

\*) T = Min. and Max. transmittable torque using a h6 cylindrical tool, full depth insert. For additional information see section Technical Information.

### Inch range

#### Technical Specification CAT form AD/B

Taper	Part no.	Item description	Dimensions, inch								T* ft·lb	Weight kg	G 2.5 at rpm
			D1	D2	D3	L1	L2	L3	depth				
40	687620-T	ECOGRIP-3/4"/CAT40	0.750	1.378	2.047	2.539	1.789	0.472	2.047	295 - 395	1.3	25 000	

\*) T = Min. and Max. transmittable torque using a h6 cylindrical tool, full depth insert. For additional information see section Technical Information.

- From stock
- On request

#### Information:

- Runout accuracy  $\leq 0.004$  mm at  $2.5 \times D1$  (max. 50 mm),  $\leq 0.00016$  inch at  $2.5 \times D1$  (max. 1.969 inch)
- Tool shank h6 or h7 can be used
- Center thread, M8x1.25, for axial length adjustment screw (screw not included)
- Coolant through on all holders
- Bore for data carrier - available on request

#### Accessories:

Use preset Torque Wrench, 10 Nm, to ensure correct mounting of tools. Part no. 19052.

ETP ECOGRIP can be used with reducing sleeves. For additional information see section Accessories.

